



Pleasant Valley Ranch

PJHSA Open Western Show

Sunday, June 5th, 2011

Judge: Jonathan Meilleur

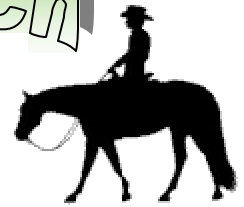

General Information

- Show starts at **9AM sharp**
- Registration & Schooling begin at **8AM**
- Show will be run according to PJHSA rules
- All pre-registration materials, driving directions & class patterns can be found on PVR & PJHSA Websites
- **Come hungry & bring lawn chairs/blankets!** ☺
- All dogs **must** be on leashes
- Current negative Coggins form required

Fees

- **\$12/class** Day-of Registration
- **\$10/class** Pre-entry (must be received by Thurs. June 2nd)
- **\$15 Entry for Payback Classes: 11, 23**

Prizes

- * **6 ribbons each class**
- * **Champion & Reserve Champion Awards for each Division**
- * **\$200 ADDED PRIZE MONEY (CLASSES 11 & 23)**
 - **1st- \$50, 2nd-\$30, 3rd-\$20**
 - **Classes must have 8 or more entries**

Divisions

Youth: *all riders 12 & under*—**MUST WEAR APPROVED HELMET ON GROUNDS!**

- Classes (7, 14, 17, 20)

Junior Novice: *13-18 years old and in first 3 years of showing*

- Classes (6, 15, 18, 21)

Junior Exhibitor: *13-18 years old*

- Classes (5, 16, 19, 22)

Adult Novice: *19+ years old and in first 3 years of showing*

- Classes (3, 26, 30, 34)

Senior Exhibitor: *19+ years old*

- Classes (2, 27, 31, 35)

Snaffle Bit: *All English or Western Junior & Senior exhibitors with horses 2-3 yrs.*

- Classes (26, 33)

Open Western Horse: *Open to all Western exhibitors & horses*

- Classes (23 **or** 24, 25, 37, 38)

Stock Horse English: *Open to all English exhibitors & horses*

- Classes (9, 10, 11, 12, 13)

Jack Benny: *exhibitors 39+ years old*

- Classes (4, 28, 32, 36)

Class List

1. Open Halter- All Ages
 2. Senior Exhibitor Showmanship*
 3. Adult Novice Showmanship*
 4. Jack Benny Showmanship*
 5. Junior Exhibitor Showmanship*
 6. Junior Novice Showmanship*
 7. Youth Showmanship*
 8. Leadline
- *****10-MINUTE SCHOOLING BREAK*****
9. Stock Horse English Pleasure W/T
 10. Stock Horse English Equitation W/T
 11. Stock Horse English Pleasure W/T/C \$
 12. Stock Horse English Equitation W/T/C
 13. Stock Horse English Equitation Pattern W/T/C*
- *****10-MINUTE SCHOOLING BREAK*****
14. Youth Walk/Jog Pleasure
 15. Junior Novice Walk/Jog Pleasure
 16. Junior Exhibitor Walk/Jog Pleasure
 17. Youth Walk/Jog Equitation
 18. Junior Novice Walk/Jog Equitation
 19. Junior Exhibitor Walk/Jog/Lope Equitation
 20. Youth Walk/Jog/Lope Pleasure
 21. Junior Novice Walk/Jog/Lope Pleasure
 22. Junior Exhibitor Walk/Jog/Lope Pleasure
- *****LUNCH BREAK*****
23. Trail* \$
 24. Walk/Jog Trail*
 25. All-Day Walk/Jog Pleasure
 26. Adult Novice Walk/Jog Pleasure
 27. Senior Exhibitor Walk/Jog Pleasure
 28. Jack Benny Walk/Jog Pleasure
 29. Snaffle Bit W/J Pleasure (2 & 3yr. Old)
 30. Adult Novice Walk/Jog Equitation
 31. Senior Exhibitor Walk/Jog/Lope Equitation
 32. Jack Benny Walk/Jog Equitation
 33. Snaffle Bit W/J/L Pleasure (2 & 3yr. Old)
 34. Adult Novice Walk/Jog/Lope Pleasure
 35. Senior Exhibitor Walk/Jog/Lope Pleasure
 36. Jack Benny Walk/Jog/Lope Pleasure
 37. Open Western Pleasure Horse
 38. Western Horsemanship*

\$ Payback Class

*Pattern available on PVR & PJHSA Websites

Pleasant Valley Ranch (formerly Open Gate Equestrian Center) 88 Arrow Road, New Ringgold, PA 17960

Show Management Contact: Alexis Schultz c:484-547-6327, email: pleasantvalleyranch@yahoo.com

Pre-registration information, class patterns and driving directions are online @ www.pleasantvalleyranch.com or www.pjhsa.com



**Pleasant Valley Ranch
PJHSA Open Western Show
Sunday, June 5th, 2011- 9am
Judge: Jonathan Meilleur**

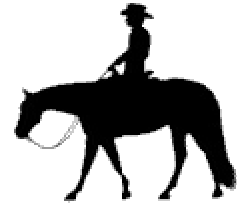

PRE-ENTRY FORM

Use a separate form for each horse/rider combination

EXHIBITOR'S NAME: _____ AGE: _____

PHONE # _____ E-MAIL: _____

ADDRESS _____

HORSE OR PONY'S NAME: _____

CLASS #'S: _____

AMOUNT ENCLOSED: \$ _____ (\$10 PER CLASS, \$15 for class 11 and 23 + \$2 office fee)

**Send Completed Form & Payment to:
Alexis Schultz
Pleasant Valley Ranch
88 Arrow Road
New Ringgold, PA 17960**

*****MUST BE POST-MARKED BY May 31st, 2010*****

SHOW RULES & INFORMATION

1. Show to be run according to PJHSA rules - a copy will be provided at secretary's stand for reference
2. All dogs must be on leashes
3. PJHSA & all show staff will not be held responsible for theft, damage, or accident to any person or animal
4. No alcoholic beverages permitted on show grounds
5. All class entries/scratches will close 2 classes prior.
6. Failure to report for a class within one minute will mean elimination
7. Notice for tack changes must be given at least one class prior
8. There will be no refund of entry money
9. There will be a returned check fee of \$40
10. Negative Coggins within 1 year is required

I agree to the above rules and hold Penn Jersey Horse Show Association and Pleasant Valley Ranch harmless for any injury or loss suffered in connection or otherwise to this show.

SIGNATURE OF EXHIBITOR OR GUARDIAN IF UNDER 18

Directions to Pleasant Valley Ranch

Pleasant Valley Ranch
88 Arrow Road
New Ringgold, PA 17960
Phone: (570) 943-2496

www.apleasantvalleyranch.com

Via Route 61

Turn onto Route 895 East. Go to New Ringgold and go across RR tracks and turn left onto Rt. 443 East. Go about 1.5 miles and turn right onto Pleasant Valley Road. Travel 2.5 miles and turn left onto Arrow Rd. The farm is 1/2 mile on the right.

From Route 309 North (Allentown, NJ)

From 309 North take 895 West. Travel about 3 miles and turn right onto Archery Club Road. Follow this road about 1.5 mi. and turn left onto Hecla Road (this turns into Pleasant Valley Road). Travel about 1 mile and turn right onto Arrow Road . The farm is about 1/2 mile on the right.

From Route 309 South (Tamaqua, Hazleton)

From Tamaqua take 309 South to route 443 West. Turn right onto 443 West and travel about 5 miles to Archery Club Road. Turn left onto Archery Club and travel about 2 miles and make a right onto Hecla Road (this turns into Pleasant Valley Road). Travel about 1 mile and turn right onto Arrow Road . The farm is about 1/2 mile on the right.

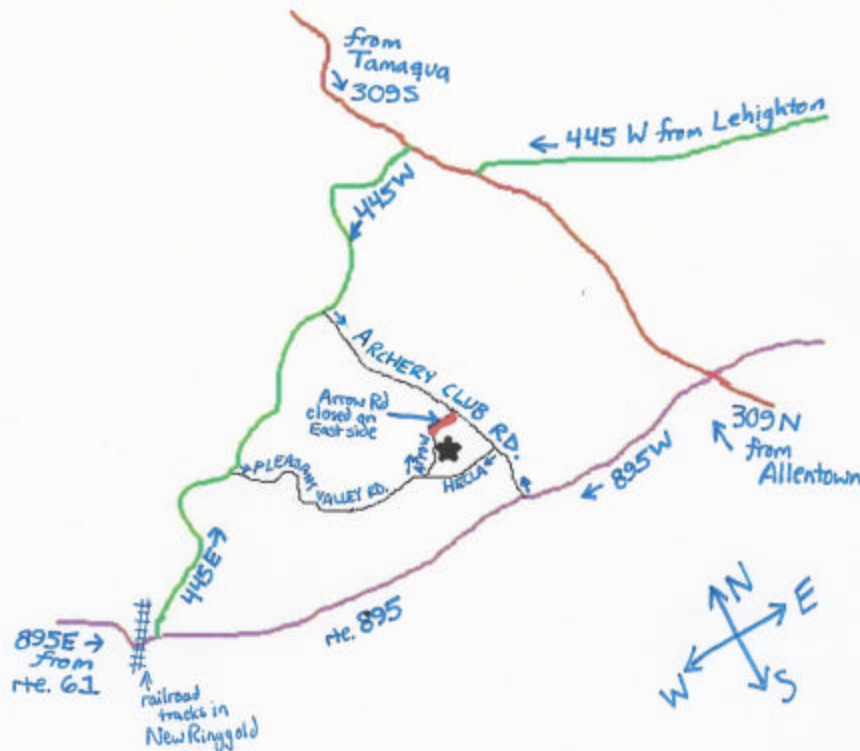

Classes 2 & 5

Senior Exhibitor & Junior Exhibitor

Showmanship

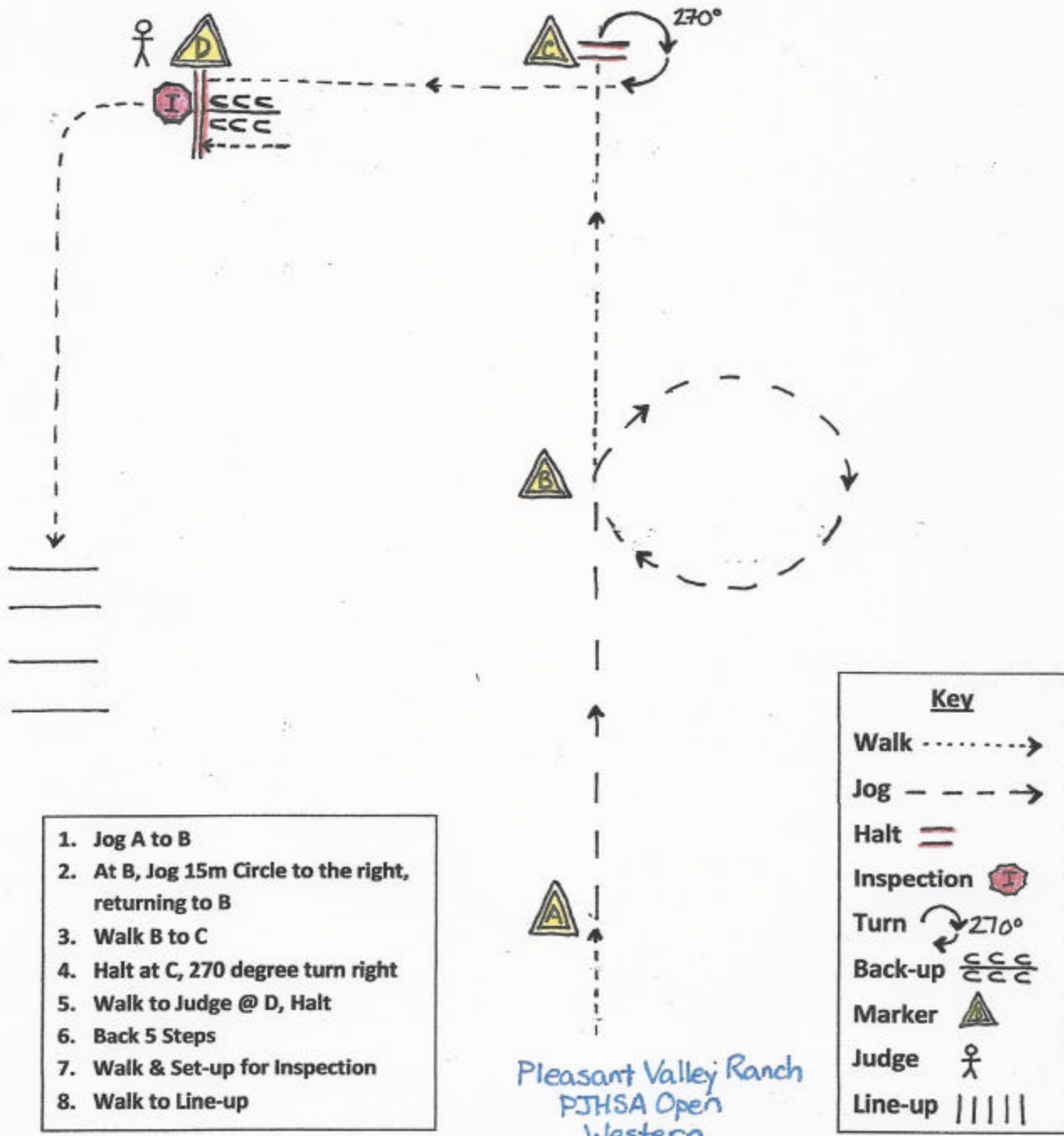

1. Jog A to B
2. At B, Jog 15m Circle to the right, returning to B
3. Walk B to C
4. Halt at C, 270 degree turn right
5. Walk to Judge @ D, Halt
6. Back 5 Steps
7. Walk & Set-up for Inspection
8. Walk to Line-up

Pleasant Valley Ranch
PJHSA Open
Western
JUNE 5th, 2011

Key	
Walk→
Jog	- - - - -→
Halt	==
Inspection	
Turn	
Back-up	
Marker	
Judge	
Line-up	

Classes 3, 4, 6, 7

Adult Novice, Jack Benny, Junior Novice & Youth Showmanship

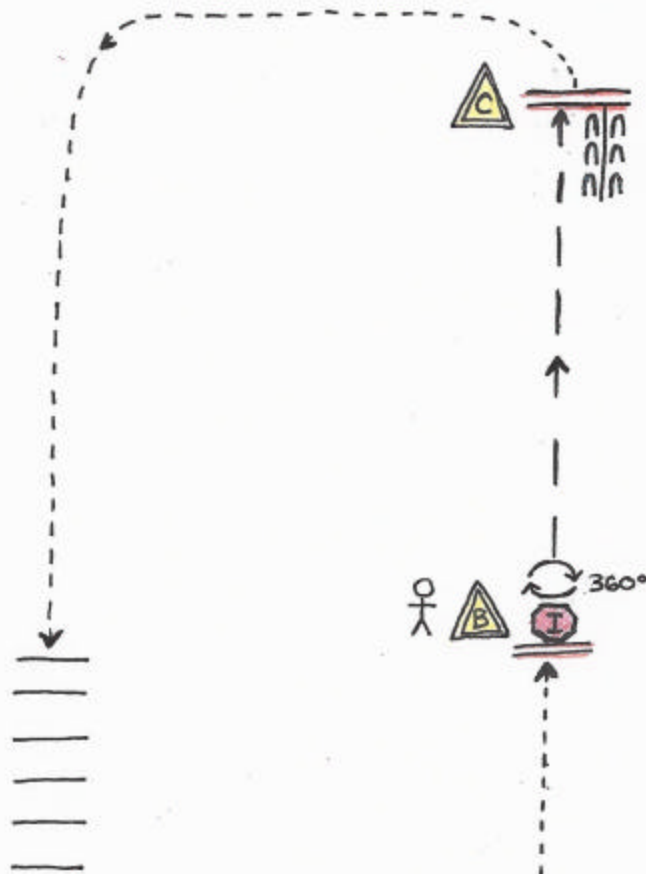

1. Walk from A to B
2. Halt & Set up for inspection
3. Perform a 360 degree turn right
4. Trot to C
5. Halt at C & Back 5 steps
6. Walk to rail & line up

Pleasant Valley Ranch
PJHSA Open
Western
JUNE 5th, 2011

Key	
Walk	----->
Jog	- - - - ->
Halt	====
Inspection	Ⓢ
Turn	↻ 360°
Back-up	≡≡≡≡
Marker	△
Judge	⊆
Line-up	

Class 13

Stock Horse English Equitation Pattern

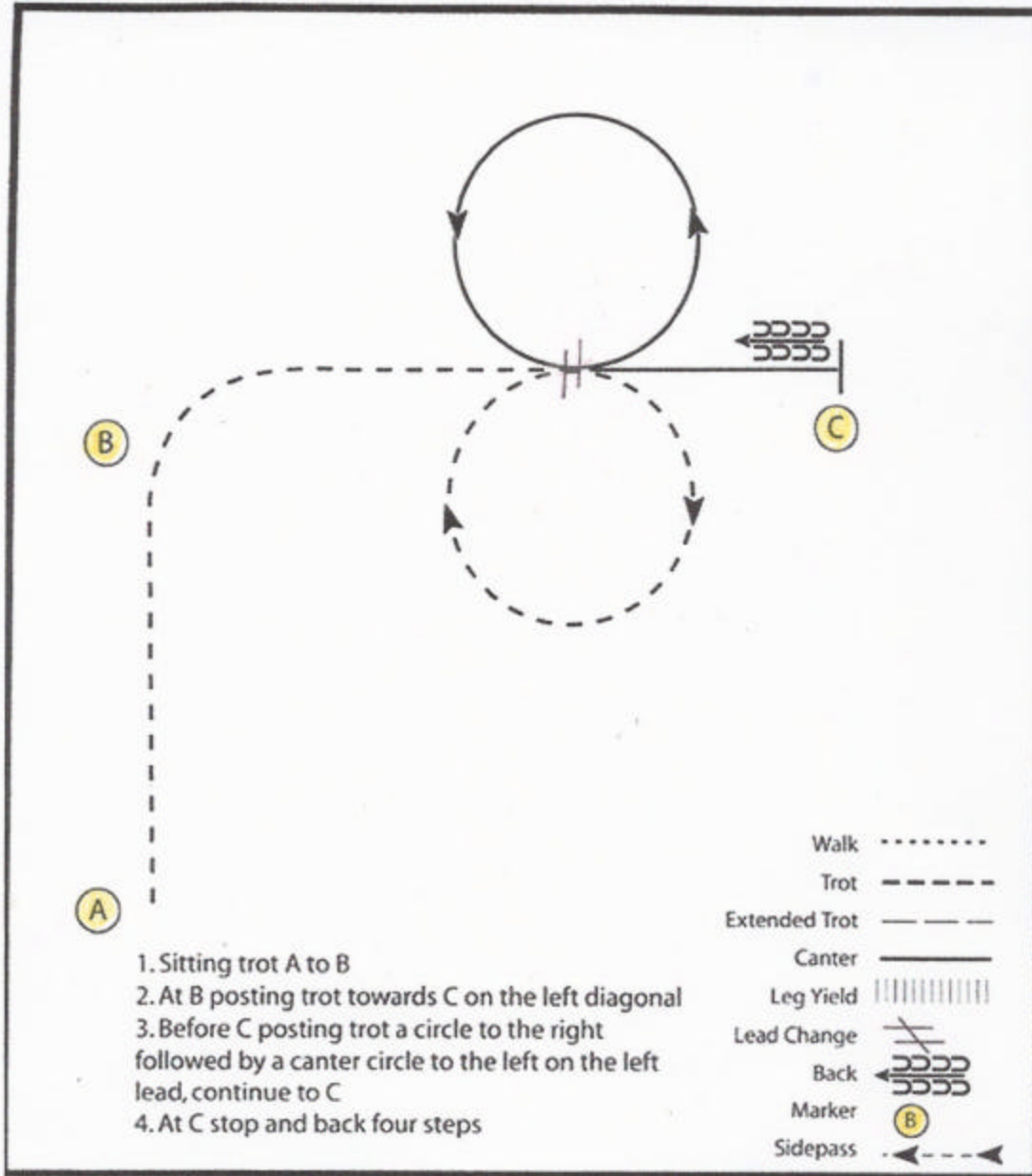

Pleasant Valley Ranch
PJHSA Open
Western
JUNE 5th, 2011

Class 22 Trail

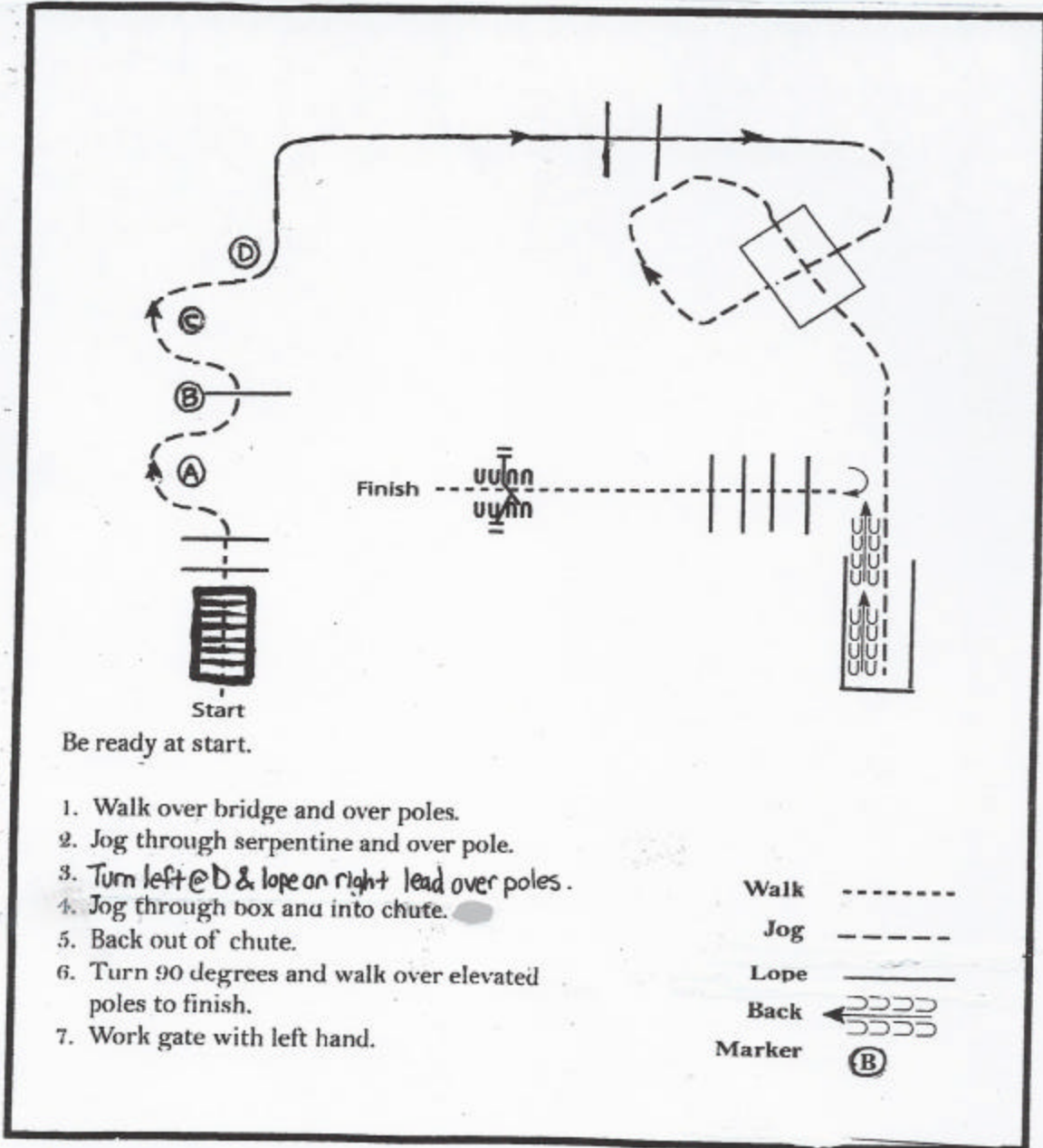

Pattern Provided by:
PJHSA

Pleasant Valley Ranch
 PJHSA Open
 Western
 JUNE 5th, 2011

Class 23
Walk/Jog Trail

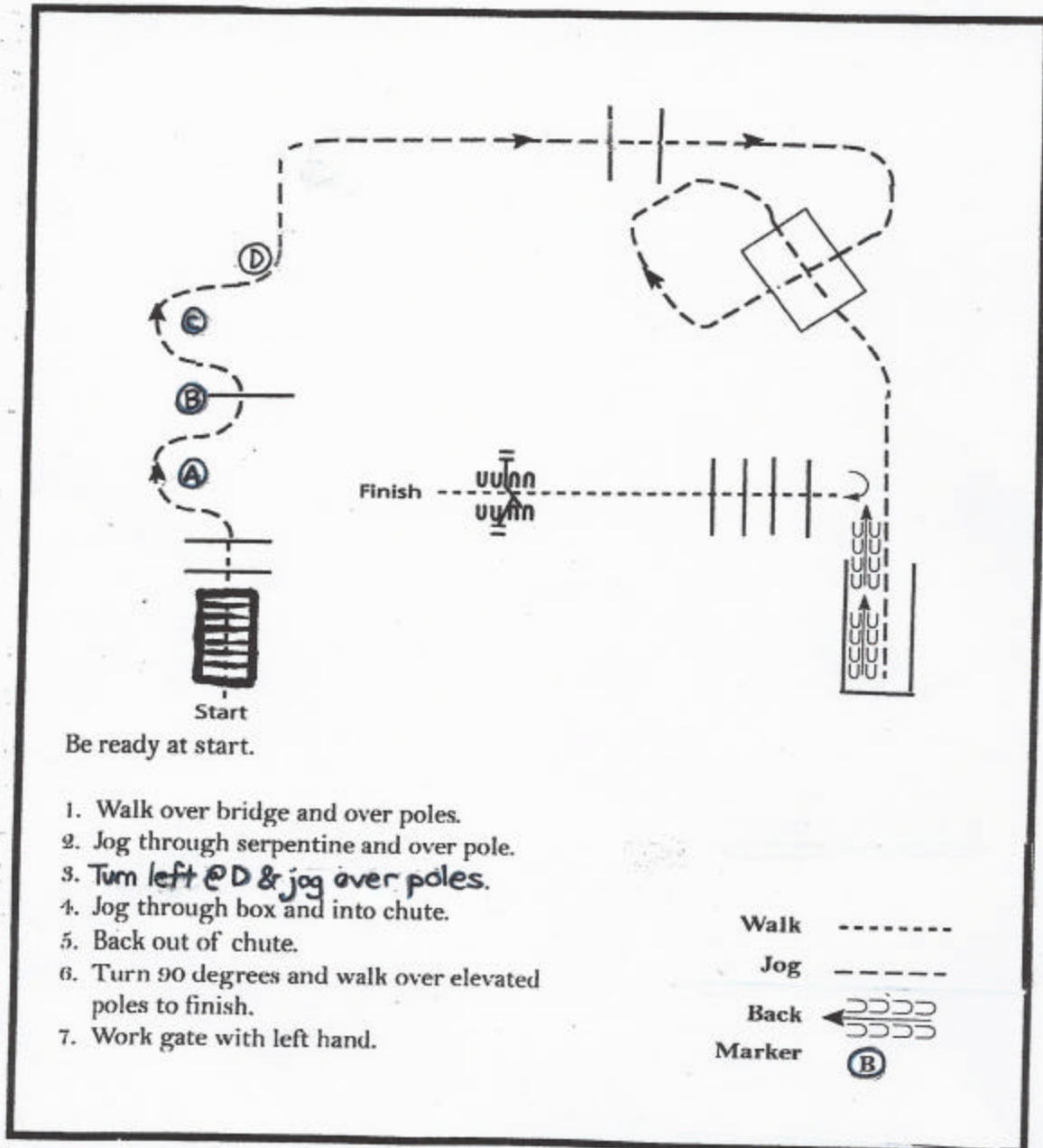

Pattern Provided by:
PJHSA

Pleasant Valley Ranch
PJHSA Open
Western
JUNE 5th, 2011

Class38

Western Horsemanship

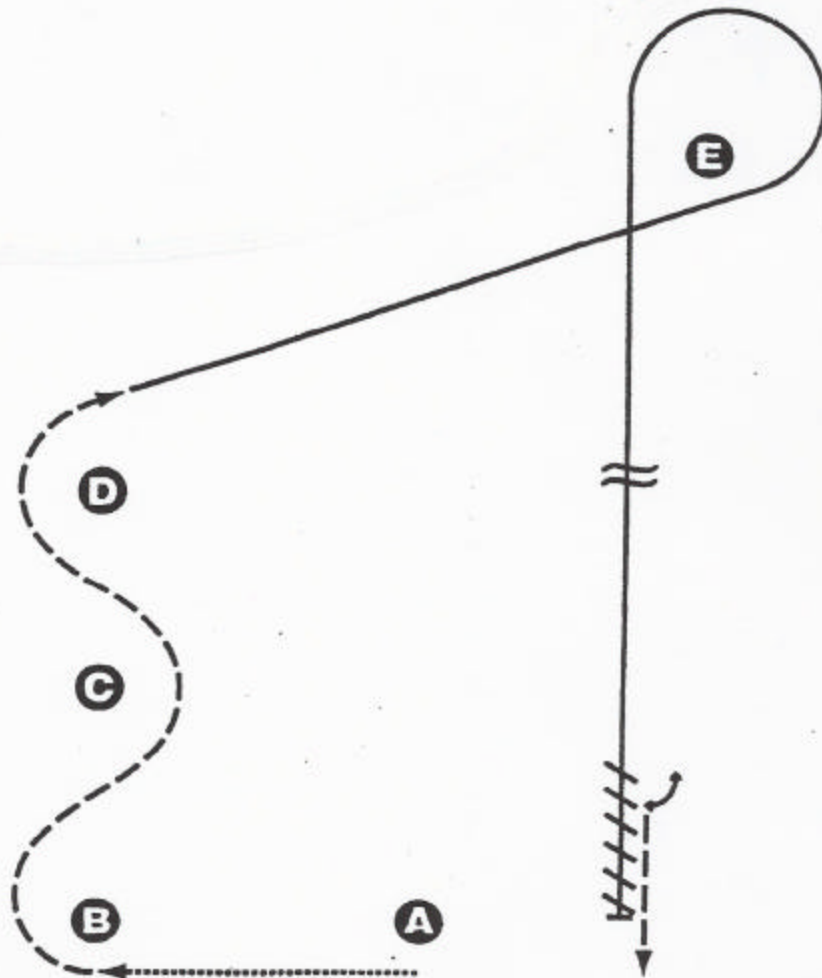

INSTRUCTIONS

1. Start at A. Walk to B.
2. At B, jog a serpentine through B, C & D.
3. When past D, lope on left lead.
4. Lope a small circle around E and back towards gate.
5. When even with D, execute a simple or flying lead change.
6. Continue on right lead until even with A. Stop.
7. Back Pivot left and pivot right.
8. Exit arena at a jog.

KEY

.....	WALK
-----	JOG
-----	EXTENDED JOG
-----	LOPE
//////	BACK
≈	CHANGE LEADS
~~~~~	SIDEPASS

Pleasant Valley Ranch  
PJHSA Open  
Western  
JUNE 5th, 2011